

Intelligent Drivesystems, Worldwide Services

SILNIKI ELEKTRYCZNE

30 – 55 kW



PL

KATALOG PRODUKTÓW
M7002

**NORD**[®]
DRIVESYSTEMS



OPCJE

SILNIKI 30 – 55 kW

| Skrót | Znaczenie |
|-------------------|--|
| BRE + | Hamulec / moment hamowania + podopcja |
| DBR + | Podwójny hamulec + podopcja |
| RG* | Wersja z ochroną antykorozyjną |
| SR* | Wersja z ochroną przeciwpyłową i antykorozyjną |
| HL | Ręczne luzowanie hamulca |
| MIK | Mikrowyłącznik |
| * nie dotyczy DBR | |
| BSH | Ogrzewanie postojowe / hamulec |
| NRB1 / 2 | Hamulec z redukcją szumów |
| ERD | Zewnętrzny zacisk uziemiający |
| TF | Czujnik temperatury, termistor PTC |
| TW | Czujnik temperatury, bimetal |
| SH | Ogrzewanie postojowe |
| WE | Drugi wał wyjściowy silnika |
| RD | Daszek ochronny |
| RDD | Podwójna osłona wentylatora |
| KB | Zamknięty otwór dla wody kondensacyjnej |
| KKV | Skrzynka zaciskowa zalana |
| FEU | Izolacja przed wilgocią |
| TRO | Izolacja tropikalna |
| VIK | Przepisy - Związek Przemysłowej Gospodarki Energetycznej |
| F | Wentylator obcy |
| RLS | Blokada ruchu wstecznego |
| IG1 (IG11, 12) | Enkoder przyrostowy, 1024 impulsów |
| IG2 (IG21, 22) | Enkoder przyrostowy, 2048 impulsów |
| IG4 (IG41, 42) | Enkoder przyrostowy, 4096 impulsów |
| IG.K | Enkoder ze skrzynką zaciskową |
| AG | Enkoder absolutny |

Informacje dotyczące opcji, które nie są przedstawione na rysunkach wymiarowych, można uzyskać na życzenie!

Standardowe konfiguracje hamulców

| Typ | | | BRE 250 | BRE 400 | BRE 800 |
|--|-----|-----|---------------------|------------|------------|
| | IE2 | IE3 | M _B [Nm] | | |
| 225 | | RP | 250 | 400 | |
| | SH | SP | 250 | 400 | |
| | MH | MP | | 400 | 800 |
| 250 | WH | WP | | 400 | 800 |
| Nadwyżka ciężaru [kg] | | | 32 | 50 | 53 |
| J [10 ⁻³ kgm ²] | | | 6,65 | 19,5 | 39 |

Aby uzyskać dalsze informacje dotyczące danych technicznych opcji i hamulców, należy zwrócić się do osoby kontaktowej z firmy NORD.

IE2 50 Hz

| Typ | P_N | n_N | M_N | I_N | | $\cos \varphi$ | η | | | $\eta^{(1)}$ | M_A/M_N | M_K/M_N | I_A/I_N | J | Cięż. |
|----------|-------|-----------|-------|-------|------|----------------|--------|--------|--------|--------------|-----------|-----------|-----------|---------------------|-------|
| | | | | 230V | 400V | | 1/2xPN | 3/4xPN | 4/4xPN | | | | | | |
| | [kW] | [obr/min] | [Nm] | [A] | [A] | | [%] | [%] | [%] | [%] | | | | [kgm ²] | [kg] |
| 225 SH/4 | 37 | 1480 | 239 | 120 | 69,5 | 0,85 | 94,4 | 94,2 | 93,7 | 93,3 | 2,6 | 3,0 | 6,9 | 0,49 | 315 |
| 225 MH/4 | 45 | 1480 | 290 | 141 | 81,4 | 0,84 | 94,4 | 94,5 | 94 | 94 | 2,6 | 2,7 | 6,9 | 0,60 | 340 |
| 250 WH/4 | 55 | 1480 | 355 | 172 | 99,3 | 0,84 | 94,2 | 94,4 | 94 | 94 | 2,7 | 3,0 | 7,4 | 0,74 | 380 |

IE2 60 Hz

| Typ | P_N | n_N | M_N | I_N | | $\cos \varphi$ | η | | | $\eta^{(1)}$ | M_A/M_N | M_K/M_N | I_A/I_N | J | Cięż. |
|----------|-------|-----------|-------|-------|------|----------------|--------|--------|--------|--------------|-----------|-----------|-----------|---------------------|-------|
| | | | | 265V | 460V | | 1/2xPN | 3/4xPN | 4/4xPN | | | | | | |
| | [kW] | [obr/min] | [Nm] | [A] | [A] | | [%] | [%] | [%] | [%] | | | | [kgm ²] | [kg] |
| 225 SH/4 | 37 | 1785 | 198 | 102 | 58,9 | 0,84 | 93,7 | 94,5 | 94,5 | 94 | 2,9 | 3,3 | 8,2 | 0,49 | 315 |
| 225 MH/4 | 45 | 1785 | 241 | 123 | 71,2 | 0,83 | 94,2 | 94,8 | 94,6 | 94,5 | 3,1 | 3,2 | 8,2 | 0,60 | 340 |
| 250 WH/4 | 55 | 1785 | 294 | 151 | 87,2 | 0,84 | 94,2 | 94,8 | 94,7 | 94,3 | 3,0 | 3,3 | 8,5 | 0,74 | 380 |

* Typ konstrukcji B5, bez opcji / $\eta^{(1)}$ Najbardziej niekorzystna wartość na granicy szerokiego zakresu

IE3 50 Hz

| Typ | P_N | n_N | M_N | I_N | | $\cos \varphi$ | η | | | M_A/M_N | M_K/M_N | I_A/I_N | J | Cięż. |
|----------|-------|-----------|-------|-------|------|----------------|--------|--------|--------|-----------|-----------|-----------|---------------------|-------|
| | | | | 230V | 400V | | 1/2xPN | 3/4xPN | 4/4xPN | | | | | |
| | [kW] | [obr/min] | [Nm] | [A] | [A] | | [%] | [%] | [%] | | | | [kgm ²] | [kg] |
| 225 RP/4 | 30 | 1485 | 193 | 97,3 | 56,2 | 0,82 | 93,6 | 94,3 | 94,1 | 3,0 | 3,4 | 7,8 | 0,49 | 315 |
| 225 SP/4 | 37 | 1485 | 238 | 118 | 68,2 | 0,83 | 93,6 | 94,4 | 94,1 | 2,9 | 3,2 | 7,7 | 0,54 | 330 |
| 225 MP/4 | 45 | 1485 | 289 | 142 | 81,7 | 0,83 | 94,6 | 94,9 | 94,6 | 3,0 | 3,4 | 8,0 | 0,67 | 365 |
| 250 WP/4 | 55 | 1480 | 355 | 166 | 96,1 | 0,87 | 95,2 | 95 | 94,6 | 2,6 | 2,8 | 7,0 | 0,82 | 400 |

IE3 60 Hz

| Typ | P_N | n_N | M_N | I_N | | $\cos \varphi$ | η | | | M_A/M_N | M_K/M_N | I_A/I_N | J | Cięż. |
|----------|-------|-----------|-------|-------|------|----------------|--------|--------|--------|-----------|-----------|-----------|---------------------|-------|
| | | | | 265V | 460V | | 1/2xPN | 3/4xPN | 4/4xPN | | | | | |
| | [kW] | [obr/min] | [Nm] | [A] | [A] | | [%] | [%] | [%] | | | | [kgm ²] | [kg] |
| 225 RP/4 | 30 | 1785 | 160 | 85,7 | 49,5 | 0,81 | 93,4 | 94,4 | 94,5 | 3,4 | 3,8 | 8,9 | 0,49 | 315 |
| 225 SP/4 | 37 | 1785 | 198 | 103 | 59,7 | 0,82 | 93,6 | 94,5 | 94,6 | 3,0 | 3,7 | 8,8 | 0,54 | 330 |
| 225 MP/4 | 45 | 1785 | 241 | 125 | 72,0 | 0,83 | 94,6 | 95,2 | 95,2 | 3,3 | 3,6 | 9,1 | 0,67 | 365 |
| 250 WP/4 | 55 | 1785 | 294 | 146 | 84,4 | 0,86 | 95,2 | 94,5 | 95,4 | 2,9 | 3,2 | 8,2 | 0,82 | 400 |

* Typ konstrukcji B5, bez opcji



SERIA NORD B3 IEC

Parametry silnika

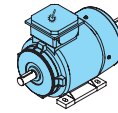
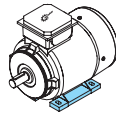
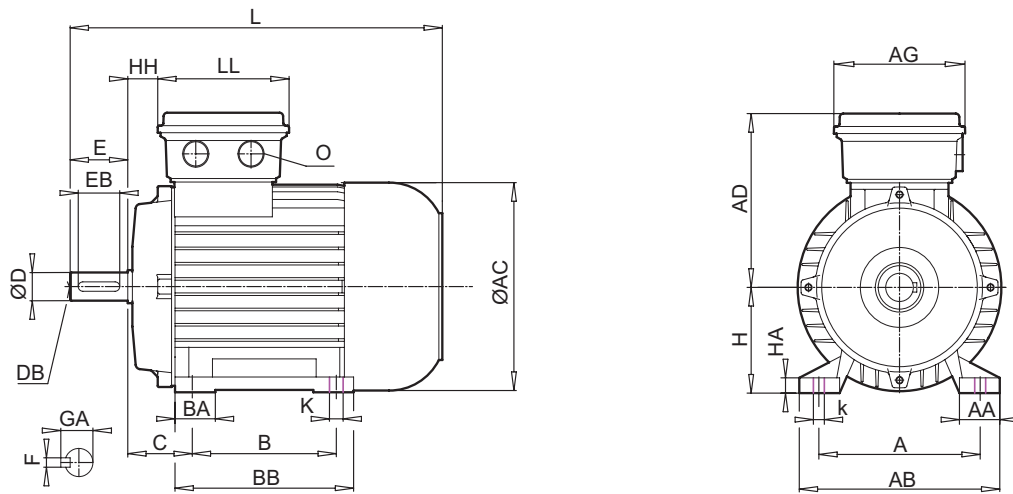

| Typ | IE2 | IE3 | [mm] | | | | | | | | | | | | | | | |
|-----|-----|-----|------|----|-----|-----|----|-----|----|----|----|-----|-----|-----|-----|-----|----|-----|
| | | | A | AA | AB | B | BA | BB | HA | k | K | AC | AD | AG | C | H | HH | L |
| 225 | SH | SP | 356 | 79 | 443 | 286 | 66 | 359 | 20 | 25 | 20 | 443 | 347 | 245 | 149 | 225 | 94 | 882 |
| 225 | MH | MP | 356 | 79 | 443 | 311 | 66 | 359 | 20 | 25 | 20 | 443 | 347 | 245 | 149 | 225 | 94 | 882 |
| 225 | | RP | 356 | 79 | 443 | 286 | 66 | 359 | 20 | 25 | 20 | 443 | 347 | 245 | 149 | 225 | 94 | 882 |

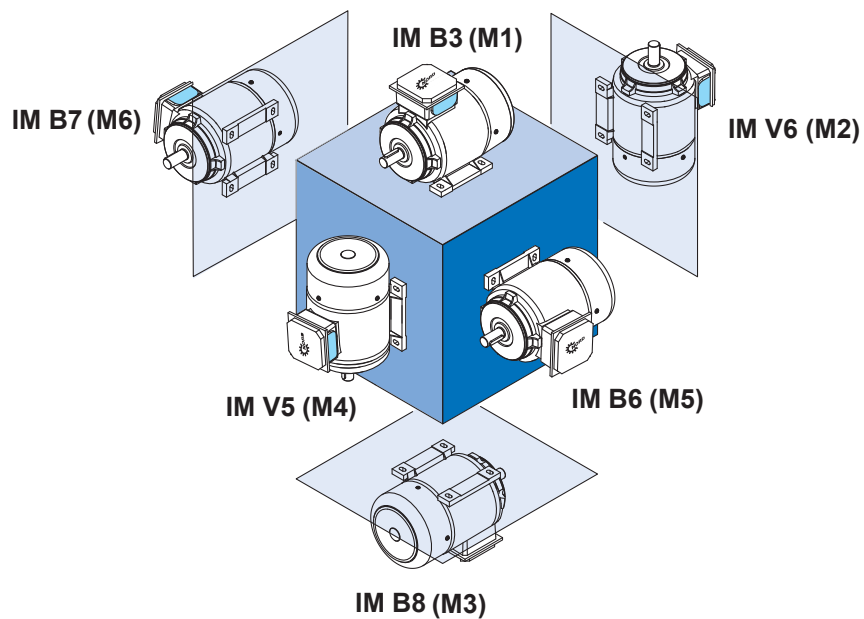

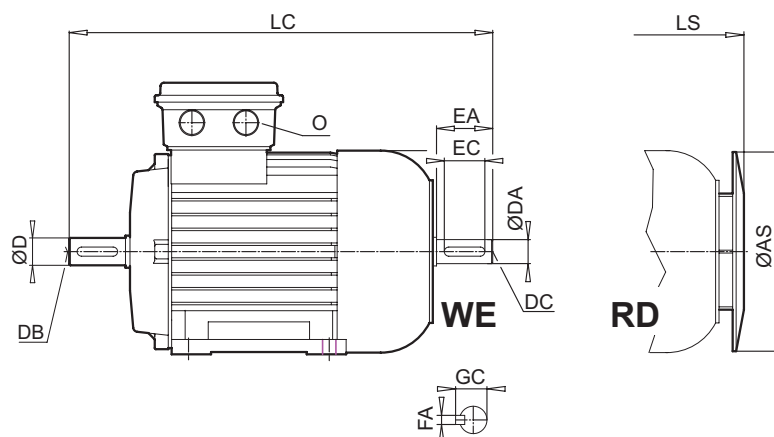

Parametry silnika

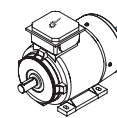
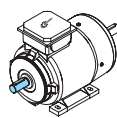
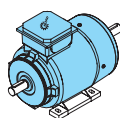

[mm]

| LC | LL | AS | LS | O | D | DB | E | EB | F | GA | DA | DC | EA | EC | FA | GC |
|------|-----|-----|-------|-----------|----|-----|-----|-----|----|----|----|-----|-----|-----|----|----|
| 1002 | 245 | 348 | 968,5 | M50 x 1,5 | 60 | M20 | 140 | 125 | 18 | 64 | 55 | M20 | 110 | 100 | 16 | 59 |
| 1002 | 245 | 348 | 968,5 | M50 x 1,5 | 60 | M20 | 140 | 125 | 18 | 64 | 55 | M20 | 110 | 100 | 16 | 59 |
| 1002 | 245 | 348 | 968,5 | M50 x 1,5 | 60 | M20 | 140 | 125 | 18 | 64 | 55 | M20 | 110 | 100 | 16 | 59 |

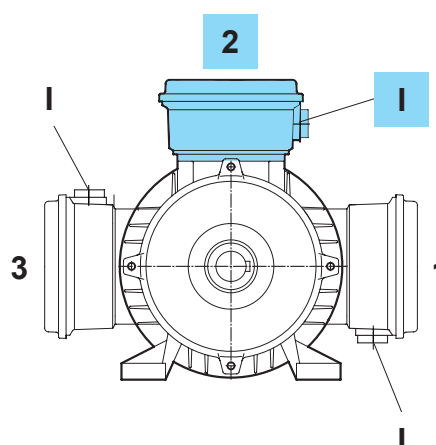
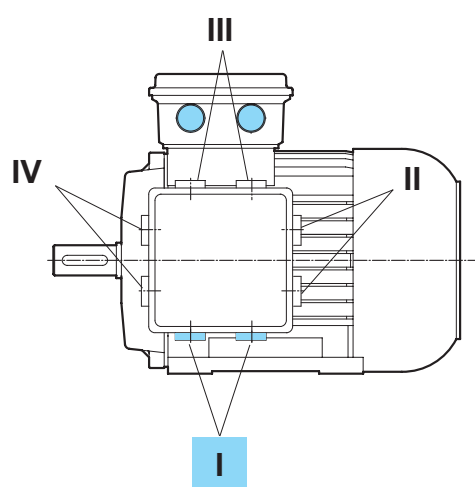

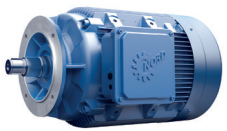

SERIA NORD B5 IEC

Parametry silnika

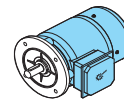
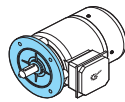
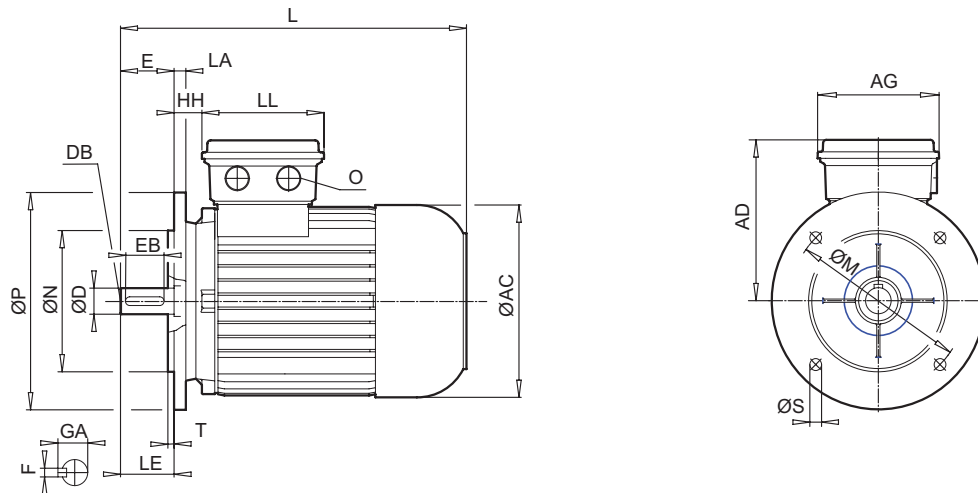

| Typ | IE2 | IE3 | [mm] | | | | | | | | | | | | | |
|-----|-----|-----|------|-----|-----|-----|------|---|-----|-----|-----|----|-----|------|-----|-----|
| | | | LA | M | N | P | S | T | AC | AD | AG | HH | L | LC | LE | LL |
| 225 | SH | SP | 20 | 400 | 350 | 450 | 17,5 | 5 | 443 | 347 | 245 | 94 | 882 | 1002 | 140 | 245 |
| 225 | MH | MP | 20 | 400 | 350 | 450 | 17,5 | 5 | 443 | 347 | 245 | 94 | 882 | 1002 | 140 | 245 |
| 225 | | RP | 20 | 400 | 350 | 450 | 17,5 | 5 | 443 | 347 | 245 | 94 | 882 | 1002 | 140 | 245 |

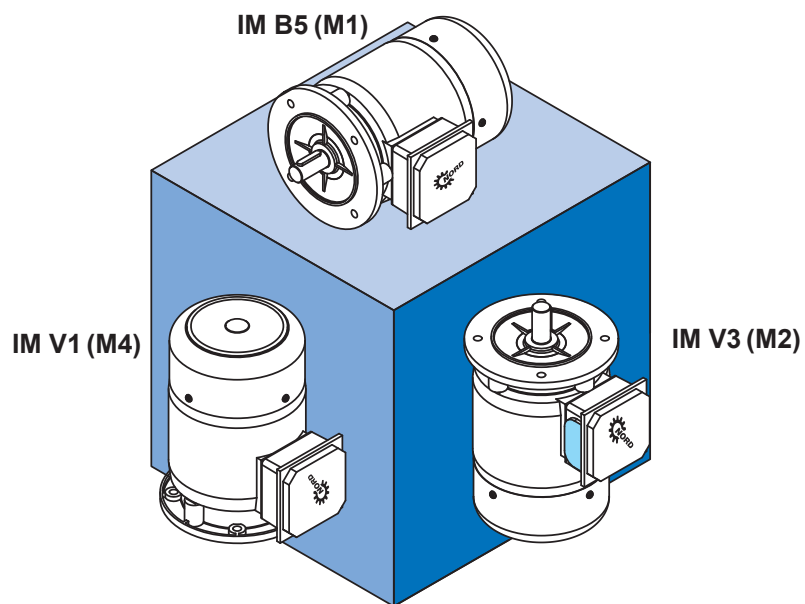

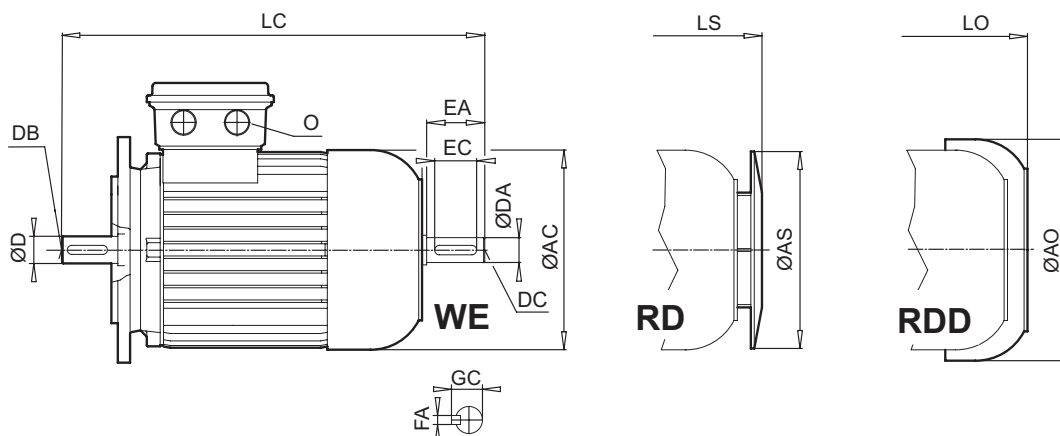

Parametry silnika

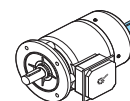
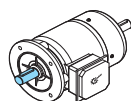
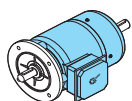

[mm]

| AS | LS | O | D | DB | E | EB | F | GA | DA | DC | EA | EC | FA | GC |
|-----|-------|-----------|----|-----|-----|-----|----|----|----|-----|-----|-----|----|----|
| 348 | 968,5 | M50 x 1,5 | 60 | M20 | 140 | 125 | 18 | 64 | 55 | M20 | 110 | 100 | 16 | 59 |
| 348 | 968,5 | M50 x 1,5 | 60 | M20 | 140 | 125 | 18 | 64 | 55 | M20 | 110 | 100 | 16 | 59 |
| 348 | 968,5 | M50 x 1,5 | 60 | M20 | 140 | 125 | 18 | 64 | 55 | M20 | 110 | 100 | 16 | 59 |

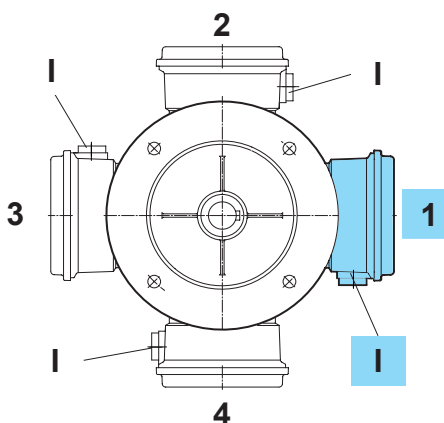
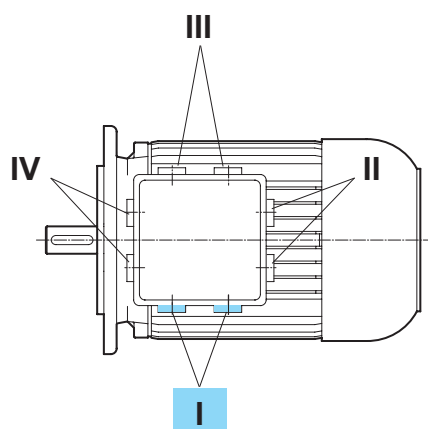



SERIA NORD IEC B3 BRE

Parametry silnika

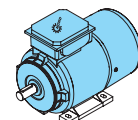
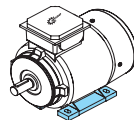
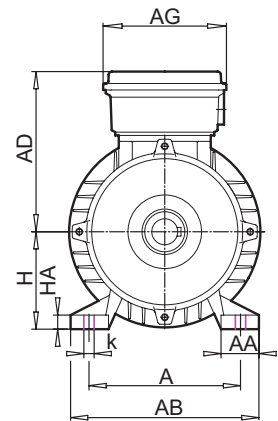
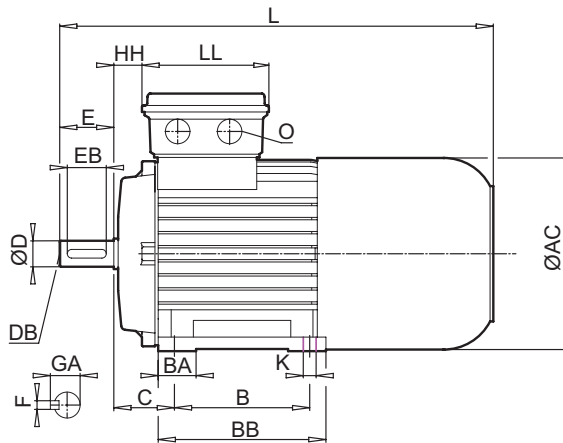

| Typ | IE2 | IE3 | [mm] | | | | | | | | | | | | | | | |
|-----|-----|-----|------|----|-----|-----|----|-----|----|----|----|-----|-----|-----|-----|-----|----|------|
| | | | A | AA | AB | B | BA | BB | HA | k | K | AC | AD | AG | C | H | HH | L |
| 225 | SH | SP | 356 | 79 | 443 | 286 | 66 | 359 | 20 | 25 | 20 | 443 | 347 | 245 | 149 | 225 | 94 | 1062 |
| 225 | MH | MP | 356 | 79 | 443 | 311 | 66 | 359 | 20 | 25 | 20 | 443 | 347 | 245 | 149 | 225 | 94 | 1062 |
| 225 | | RP | 356 | 79 | 443 | 286 | 66 | 359 | 20 | 25 | 20 | 443 | 347 | 245 | 149 | 225 | 94 | 1062 |

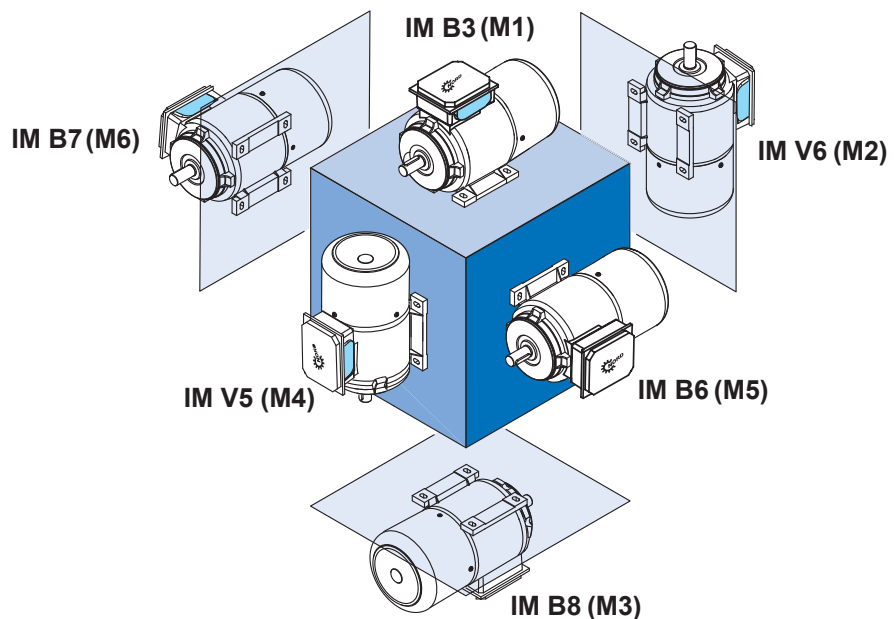

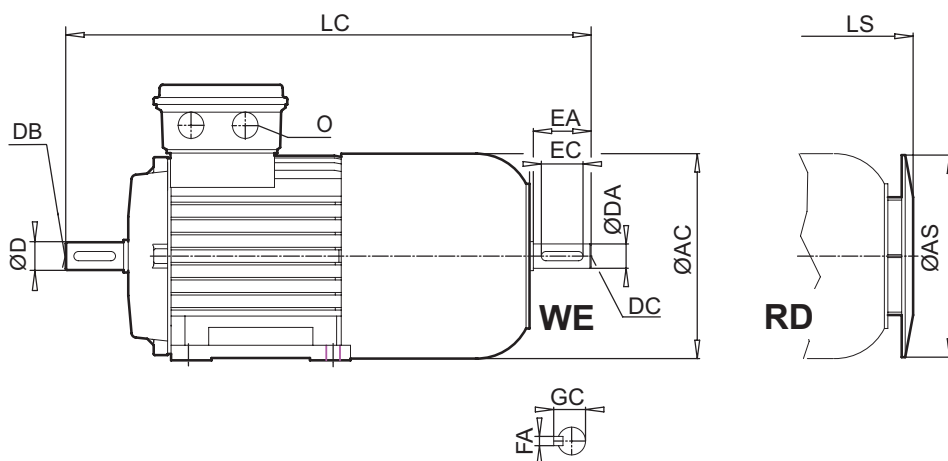

Parametry silnika

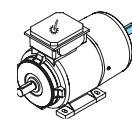
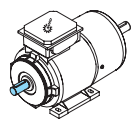
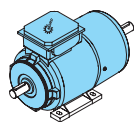

[mm]

| LC | LL | AS | LS | O | D | DB | E | EB | F | GA | DA | DC | EA | EC | FA | GC |
|------|-----|-----|--------|-----------|----|-----|-----|-----|----|----|----|-----|-----|-----|----|----|
| 1182 | 245 | 348 | 1148,5 | M50 x 1,5 | 60 | M20 | 140 | 125 | 18 | 64 | 55 | M20 | 110 | 100 | 16 | 59 |
| 1182 | 245 | 348 | 1148,5 | M50 x 1,5 | 60 | M20 | 140 | 125 | 18 | 64 | 55 | M20 | 110 | 100 | 16 | 59 |
| 1182 | 245 | 348 | 1148,5 | M50 x 1,5 | 60 | M20 | 140 | 125 | 18 | 64 | 55 | M20 | 110 | 100 | 16 | 59 |

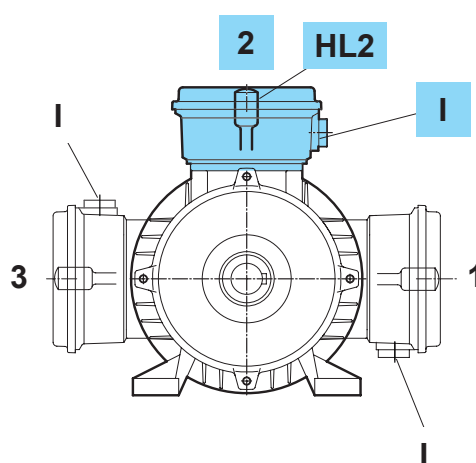
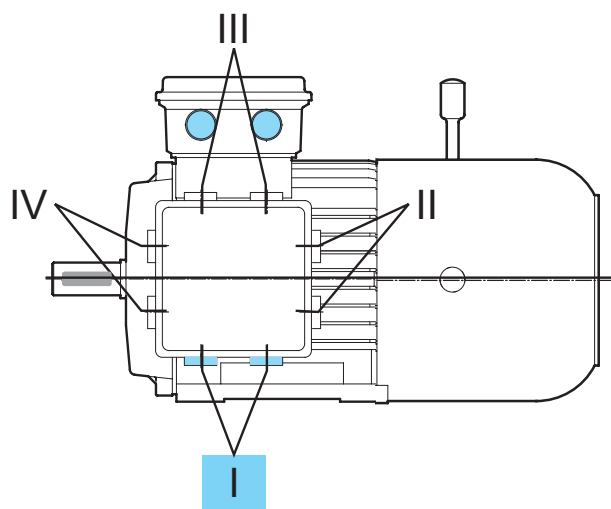



SERIA NORD IEC B5 BRE

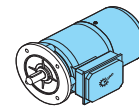
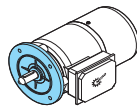
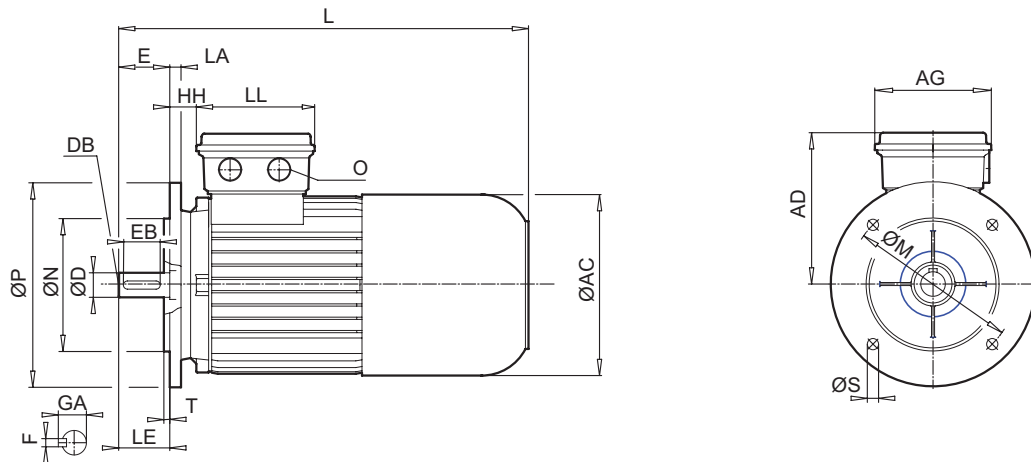

| Typ | IE2 | IE3 | [mm] | | | | | | | | | | | | |
|-----|-----|-----|------|-----|-----|-----|------|---|-----|-----|-----|----|------|------|-----|
| | | | LA | M | N | P | S | T | AC | AD | AG | HH | L | LC | LL |
| 225 | SH | SP | 20 | 400 | 350 | 450 | 17,5 | 5 | 443 | 347 | 245 | 94 | 1062 | 1182 | 245 |
| 225 | MH | MP | 20 | 400 | 350 | 450 | 17,5 | 5 | 443 | 347 | 245 | 94 | 1062 | 1182 | 245 |
| 225 | | RP | 20 | 400 | 350 | 450 | 17,5 | 5 | 443 | 347 | 245 | 94 | 1062 | 1182 | 245 |

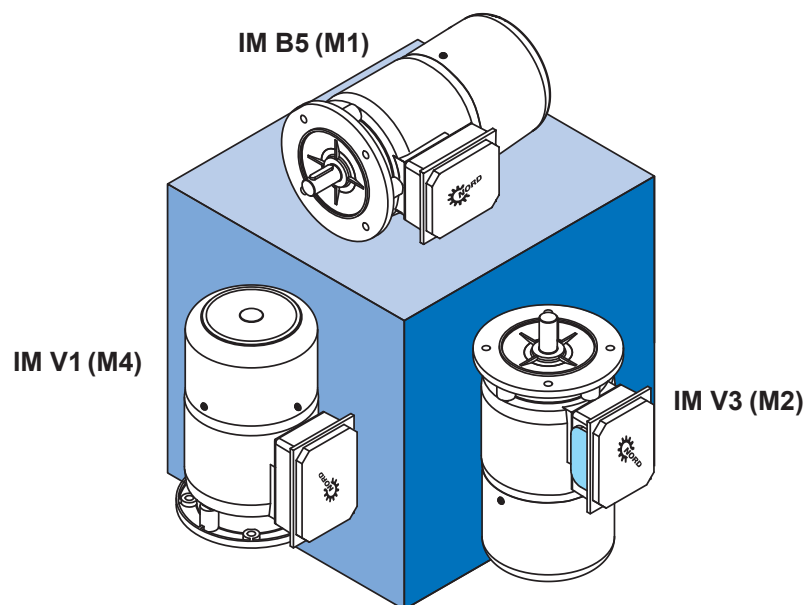

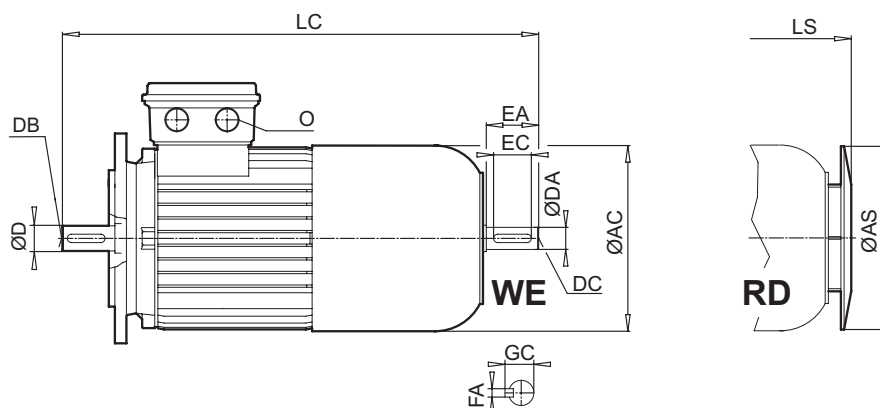

Parametry silnika

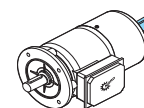
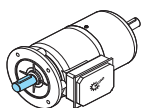
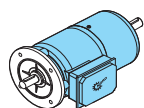

[mm]

| AS | LS | O | D | DB | E | EB | F | GA | DA | DC | EA | EC | FA | GC |
|-----|--------|-----------|----|-----|-----|-----|----|----|----|-----|-----|-----|----|----|
| 348 | 1148,5 | M50 x 1,5 | 60 | M20 | 140 | 125 | 18 | 64 | 55 | M20 | 110 | 100 | 16 | 59 |
| 348 | 1148,5 | M50 x 1,5 | 60 | M20 | 140 | 125 | 18 | 64 | 55 | M20 | 110 | 100 | 16 | 59 |
| 348 | 1148,5 | M50 x 1,5 | 60 | M20 | 140 | 125 | 18 | 64 | 55 | M20 | 110 | 100 | 16 | 59 |

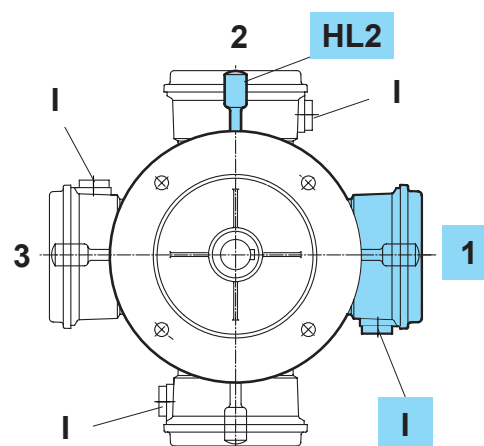
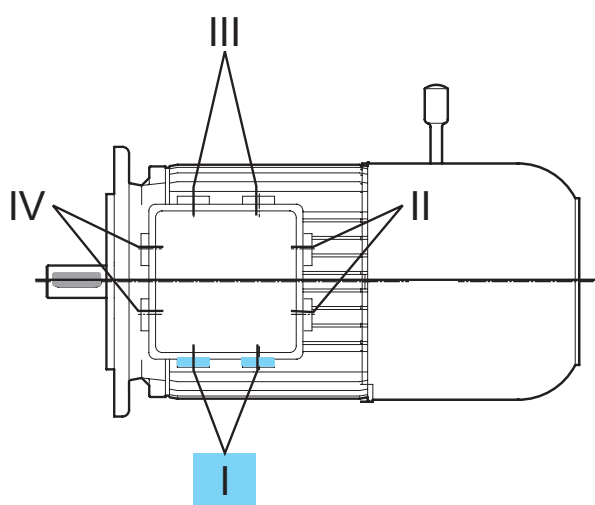

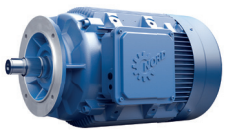

SERIA NORD B5 NORMA FABRYCZNA

Parametry silnika

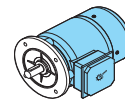
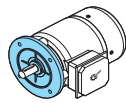
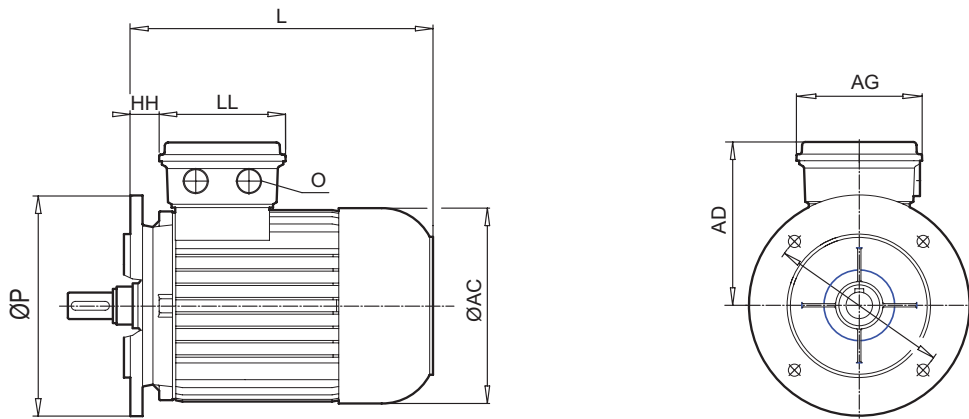

| Typ | IE2 | IE3 | [mm] | | | | | | | | |
|-----|-----|-----|------|---------|-----|-----|-----|----|-----|-----|-----|
| | | | | Poz. WN | P | AC | AD | AG | HH | L | LC |
| 225 | SH | | 28 | 350 | 433 | 347 | 245 | 94 | 742 | 862 | 245 |
| 225 | SH | | 78 | 350 | 443 | 347 | 245 | 94 | 742 | 862 | 245 |
| 225 | SH | | 69 | 300 | 443 | 347 | 245 | 94 | 742 | 862 | 245 |
| 225 | MH | | 30 | 350 | 443 | 347 | 245 | 94 | 742 | 862 | 245 |
| 225 | MH | | 80 | 350 | 443 | 347 | 245 | 94 | 742 | 862 | 245 |
| 250 | WH | | 32 | 450 | 443 | 347 | 245 | 94 | 742 | 892 | 245 |
| 250 | WH | | 82 | 450 | 443 | 347 | 245 | 94 | 742 | 892 | 245 |
| 225 | | RP | 26 | 350 | 443 | 347 | 245 | 94 | 742 | 862 | 245 |
| 225 | | RP | 76 | 350 | 443 | 347 | 245 | 94 | 742 | 862 | 245 |
| 225 | | RP | 68 | 300 | 443 | 347 | 245 | 94 | 742 | 862 | 245 |
| 225 | | SP | 28 | 350 | 443 | 347 | 245 | 94 | 742 | 862 | 245 |
| 225 | | SP | 78 | 350 | 443 | 347 | 245 | 94 | 742 | 862 | 245 |
| 225 | | SP | 69 | 350 | 443 | 347 | 245 | 94 | 742 | 862 | 245 |
| 225 | | MP | 30 | 350 | 443 | 347 | 245 | 94 | 742 | 862 | 245 |
| 225 | | MP | 80 | 350 | 443 | 347 | 245 | 94 | 742 | 862 | 245 |
| 250 | | WP | 32 | 450 | 443 | 347 | 245 | 94 | 742 | 892 | 245 |
| 250 | | WP | 82 | 450 | 443 | 347 | 245 | 94 | 742 | 892 | 245 |

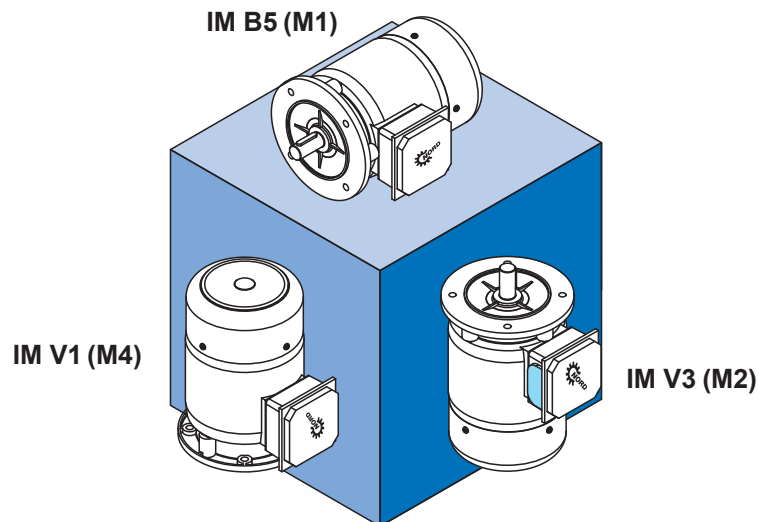

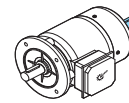
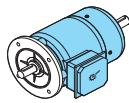
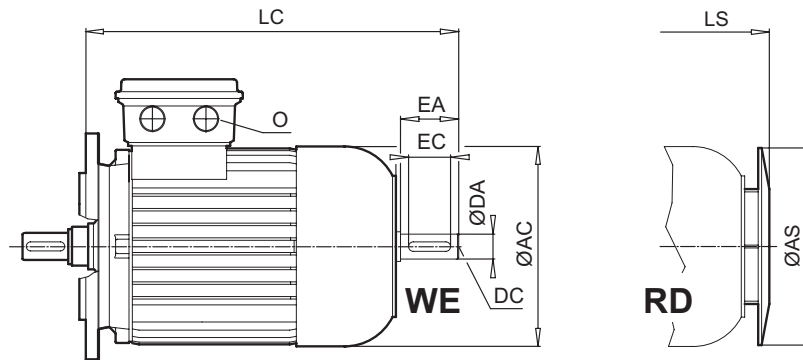

| [mm] | AS | LS | O | DA | DC | EA | EC | FA | GC |
|------|-----|-------|-----------|----|-----|-----|-----|----|----|
| | 348 | 828,5 | M50 x 1,5 | 55 | M20 | 110 | 100 | 16 | 59 |
| | 348 | 828,5 | M50 x 1,5 | 55 | M20 | 110 | 100 | 16 | 59 |
| | 348 | 828,5 | M50 x 1,5 | 55 | M20 | 110 | 100 | 16 | 59 |
| | 348 | 828,5 | M50 x 1,5 | 55 | M20 | 110 | 100 | 16 | 59 |
| | 348 | 828,5 | M50 x 1,5 | 55 | M20 | 110 | 100 | 16 | 59 |
| | 348 | 828,5 | M63 X 1,5 | 60 | M20 | 140 | 125 | 18 | 64 |
| | 348 | 828,5 | M63 X 1,5 | 60 | M20 | 140 | 125 | 18 | 64 |
| | 348 | 828,5 | M50 X 1,5 | 55 | M20 | 110 | 100 | 16 | 59 |
| | 348 | 828,5 | M50 X 1,5 | 55 | M20 | 110 | 100 | 16 | 59 |
| | 348 | 828,5 | M50 X 1,5 | 55 | M20 | 110 | 100 | 16 | 59 |
| | 348 | 828,5 | M50 X 1,5 | 55 | M20 | 110 | 100 | 16 | 59 |
| | 348 | 828,5 | M50 X 1,5 | 55 | M20 | 110 | 100 | 16 | 59 |
| | 348 | 828,5 | M50 X 1,5 | 55 | M20 | 110 | 100 | 16 | 59 |
| | 348 | 828,5 | M50 X 1,5 | 55 | M20 | 110 | 100 | 16 | 59 |
| | 348 | 828,5 | M50 X 1,5 | 55 | M20 | 110 | 100 | 16 | 59 |
| | 348 | 828,5 | M63 X 1,5 | 60 | M20 | 140 | 125 | 18 | 64 |
| | 348 | 828,5 | M63 X 1,5 | 60 | M20 | 140 | 125 | 18 | 64 |

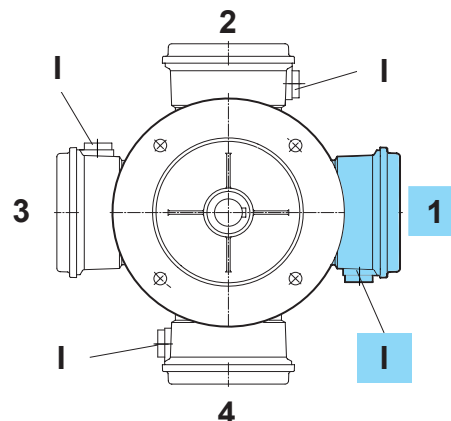
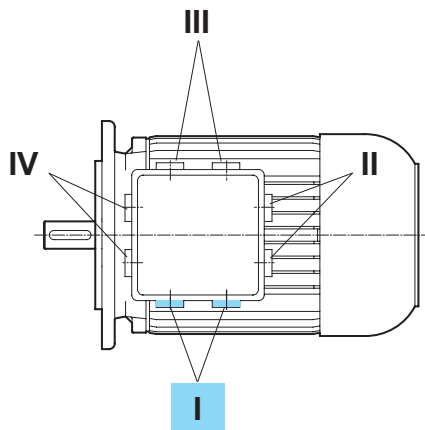



SERIA NORD

B5 BRE NORMA FABRYCZNA

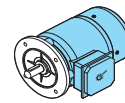
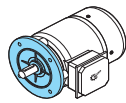
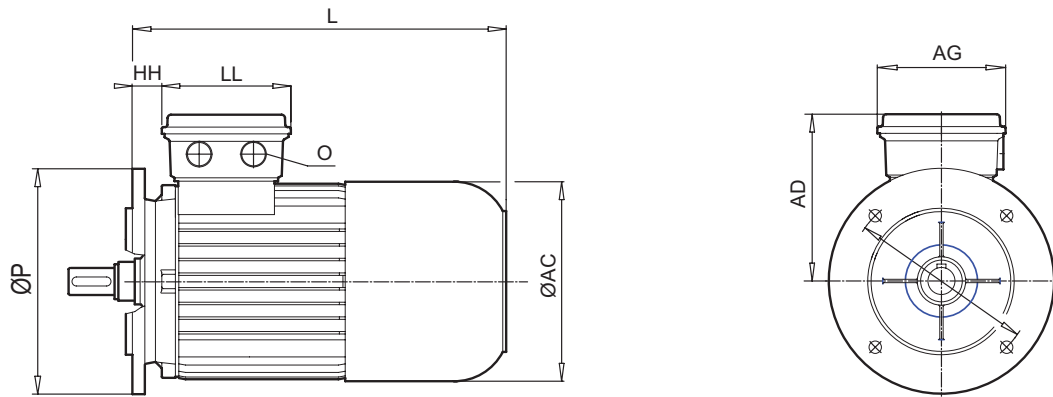

| Typ | IE2 | IE3 | [mm] | | | | | | | | | |
|-----|-----|-----|------|---------|-----|-----|-----|-----|----|-----|------|-----|
| | | | | Poz. WN | P | AC | AD | AG | HH | L | LC | LL |
| 225 | SH | | | 28 | 350 | 433 | 347 | 245 | 94 | 922 | 1042 | 245 |
| 225 | SH | | | 78 | 350 | 443 | 347 | 245 | 94 | 922 | 1042 | 245 |
| 225 | SH | | | 69 | 300 | 443 | 347 | 245 | 94 | 922 | 1042 | 245 |
| 225 | MH | | | 30 | 350 | 443 | 347 | 245 | 94 | 922 | 1042 | 245 |
| 225 | MH | | | 80 | 350 | 443 | 347 | 245 | 94 | 922 | 1042 | 245 |
| 250 | WH | | | 32 | 450 | 443 | 347 | 245 | 94 | 922 | 1072 | 245 |
| 250 | WH | | | 82 | 450 | 443 | 347 | 245 | 94 | 922 | 1072 | 245 |
| 225 | | RP | | 26 | 350 | 443 | 347 | 245 | 94 | 922 | 1042 | 245 |
| 225 | | RP | | 76 | 350 | 443 | 347 | 245 | 94 | 922 | 1042 | 245 |
| 225 | | RP | | 68 | 300 | 443 | 347 | 245 | 94 | 922 | 1042 | 245 |
| 225 | | SP | | 28 | 350 | 443 | 347 | 245 | 94 | 922 | 1042 | 245 |
| 225 | | SP | | 78 | 350 | 443 | 347 | 245 | 94 | 922 | 1042 | 245 |
| 225 | | SP | | 69 | 350 | 443 | 347 | 245 | 94 | 922 | 1042 | 245 |
| 225 | | MP | | 30 | 350 | 443 | 347 | 245 | 94 | 922 | 1042 | 245 |
| 225 | | MP | | 80 | 350 | 443 | 347 | 245 | 94 | 922 | 1042 | 245 |
| 250 | | WP | | 32 | 450 | 443 | 347 | 245 | 94 | 922 | 1072 | 245 |
| 250 | | WP | | 82 | 450 | 443 | 347 | 245 | 94 | 922 | 1072 | 245 |

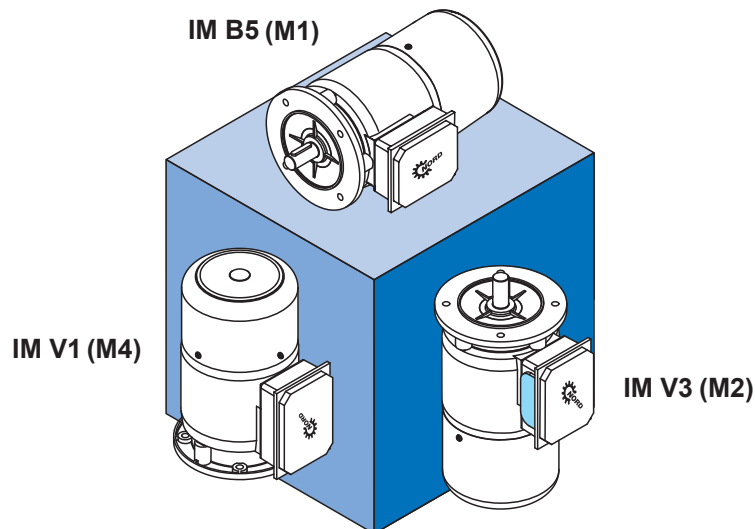

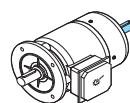
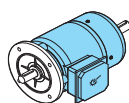
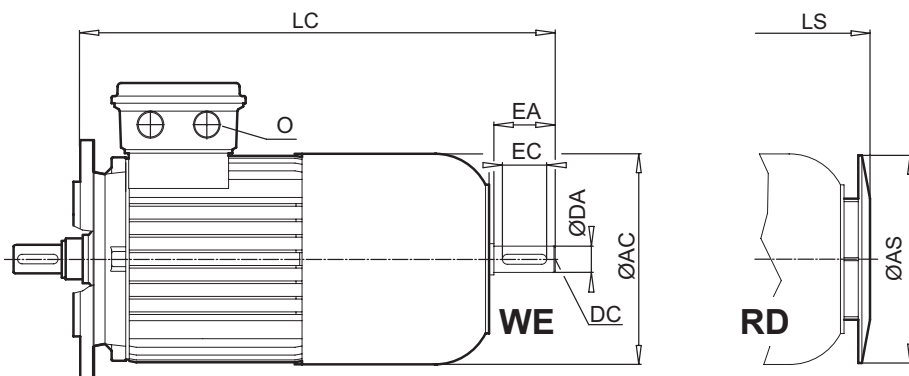

| [mm] | AS | LS | O | DA | DC | EA | EC | FA | GC |
|------|-----|--------|-----------|----|-----|-----|-----|----|----|
| | 348 | 1008,5 | M50 x 1,5 | 55 | M20 | 110 | 100 | 16 | 59 |
| | 348 | 1008,5 | M50 x 1,5 | 55 | M20 | 110 | 100 | 16 | 59 |
| | 348 | 1008,5 | M50 x 1,5 | 55 | M20 | 110 | 100 | 16 | 59 |
| | 348 | 1008,5 | M50 x 1,5 | 55 | M20 | 110 | 100 | 16 | 59 |
| | 348 | 1008,5 | M50 x 1,5 | 55 | M20 | 110 | 100 | 16 | 59 |
| | 348 | 1008,5 | M63 X 1,5 | 60 | M20 | 140 | 125 | 18 | 64 |
| | 348 | 1008,5 | M63 X 1,5 | 60 | M20 | 140 | 125 | 18 | 64 |
| | 348 | 1008,5 | M50 X 1,5 | 55 | M20 | 110 | 100 | 16 | 59 |
| | 348 | 1008,5 | M50 X 1,5 | 55 | M20 | 110 | 100 | 16 | 59 |
| | 348 | 1008,5 | M50 X 1,5 | 55 | M20 | 110 | 100 | 16 | 59 |
| | 348 | 1008,5 | M50 X 1,5 | 55 | M20 | 110 | 100 | 16 | 59 |
| | 348 | 1008,5 | M50 X 1,5 | 55 | M20 | 110 | 100 | 16 | 59 |
| | 348 | 1008,5 | M50 X 1,5 | 55 | M20 | 110 | 100 | 16 | 59 |
| | 348 | 1008,5 | M50 X 1,5 | 55 | M20 | 110 | 100 | 16 | 59 |
| | 348 | 1008,5 | M50 X 1,5 | 55 | M20 | 110 | 100 | 16 | 59 |
| | 348 | 1008,5 | M63 X 1,5 | 60 | M20 | 140 | 125 | 18 | 64 |
| | 348 | 1008,5 | M63 X 1,5 | 60 | M20 | 140 | 125 | 18 | 64 |

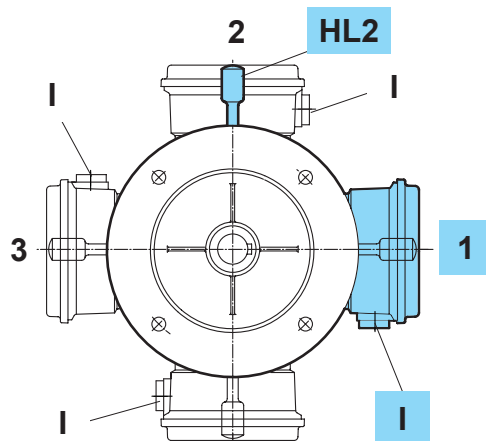
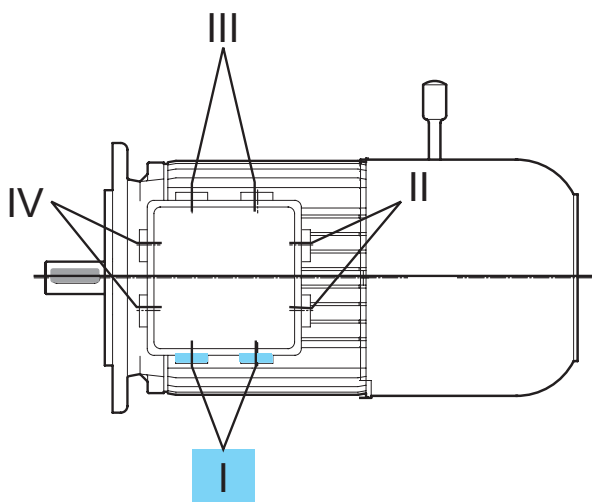



NORD DRIVESYSTEMS Group

Siedziba i technologii Centrum
w Bargteheide koło Hamburga

Innowacyjne rozwiązania napędowe
ponad 100 branżach

Produktów mechanicznych
Reduktory walcowe, walcowe w korpusie płaskim,
walcowo-stożkowe i walcowo-ślimakowe

Produktów elektryczne
Silniki elektryczne w wszystkich klas efektywności

Produktów elektroniczne
Scentralizowane i zdecentralizowane przetwornica częstotliwości,
Silnik rozrusznik

7 miejsca produkcji zaawansowanych technologicznie
dla wszystkich komponenty napędowych

Oddziały i partnerzy dystrybucyjni w 89 krajach na 5 kontynentach
zapewnienie na składowisku, centra montażowe,
pomoc techniczna i obsługa klienta

Ponad 4 000 pracowników na całym świecie
utworzyć niestandardowych rozwiązań

www.nord.com/locator

PL Nord Napędy sp. z o.o., ul. Krakowska 58, 32-020 Wieliczka
Tel. +48-122889900, Faks +48-122889911, biuro@nord.com

Members of the NORD DRIVESYSTEMS GROUP

DRIVESYSTEMS

A6030 Nr art. 6003313 / 2416